

## Care and Maintenance of an Inflatable Lifejacket

1. Visually inspect the inflatable lifejacket – looking for any tears / defects / holes in the fabric and straps, ensure the buckles are not broken.

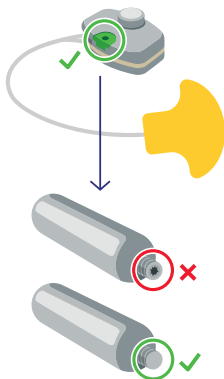

2. Although the indicator will show green if the cartridge is good and red if it needs to be replaced, it is recommended to visually inspect the CO<sub>2</sub> cartridge to ensure it isn't punctured and there are no signs of deterioration.
3. Most CO<sub>2</sub> cartridges do not indicate an expiration date, however, consider replacing it every five years.
4. Check the inflator mechanism for corrosion and proper operation before reinstalling the CO<sub>2</sub> cartridge.



5. Fully inflate the lifejacket using the manual inflation tube and leave overnight. This is to ensure that there are no leaks.
6. If the lifejacket has lost any air – properly dispose of and replace it with a new one.

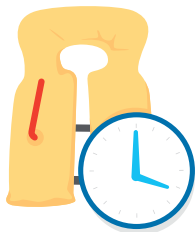

- 
7. If the lifejacket holds air, ensure it is completely dry before deflating and repacking for use.



Clean your inflatable lifejacket with warm water and a mild soap solution. Use a damp cloth or sponge to gently wash and rinse thoroughly. The best practice is to remove the CO<sub>2</sub> cartridge and, in the case of an automatic inflatable lifejacket, remove the indicator cap and bobbin to eliminate an accidental inflation. Hang and allow to air dry completely, before reinstalling the cartridge (and indicator cap and bobbin if applicable), and then repack. When not in use, store your inflatable lifejacket in a dry area out of direct sunlight.